

**SITE PLAN**  
1 : 100

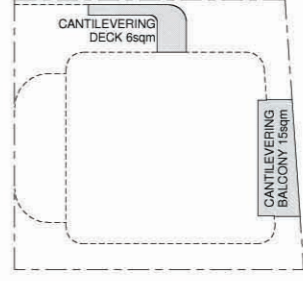
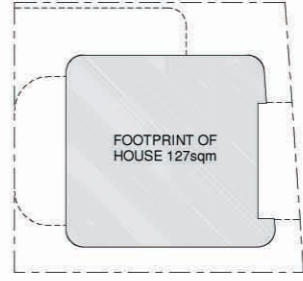
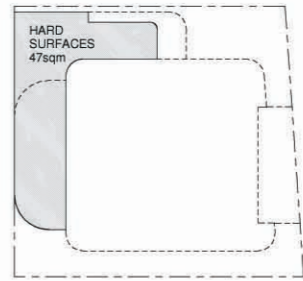
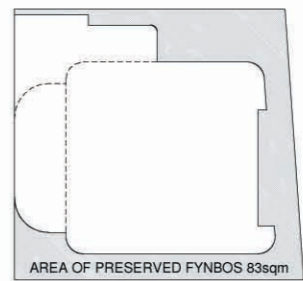
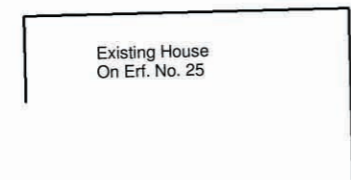

**AREAS**  
1 : 200

**SPECIFICATIONS**  
All work to be done from figured dimensions only. All work must comply with National Building Regulations SABS 0400. All dimensions and levels to be confirmed on site prior to the commencement of work. All dimensions of any component. All dimensions to be confirmed on site before ordering of any component.

**STEELWORK & GALVANIZING**  
All steelwork components to be formalized as shop drawings and issued for scrutiny by the architects and the engineers. Manufacture of steel components may only commence once shop drawings have been approved by the architects and the engineers. Sundry of shop drawings by the architects and the engineers is a courtesy and does not absolve the contractor nor sub-contractors from their responsibility of correctly manufacturing and installing steel components. All steelwork to be hot dip galvanized. All hot dip galvanizing to be carried out in accordance with SANS 121 (ISO 1461) and the recommendations of The Hot Dip Galvanizing Association of Southern Africa. All steel to be cut, grinded, drilled and welded prior to galvanizing. Any deviation from the architects drawings and engineers drawings to be approved by the architects and the engineers and formalized as shop drawings. On site cutting, grinding, drilling and welding may only be done with the approval of both the architects and the engineers. All repair work to galvanizing to be done using Zincin' zinc rich epoxy paint and to comply with SANS 121 (ISO 1461).

**NOT FOR CONSTRUCTION**

Rev.	Description	Date	Drawn
1	Issued to Ross Cameron	03/05/2010	R.McG
2	Areas included	07/06/2010	R.McG
3	Full-Flow outlets specified	30/08/2010	R.McG
4	Issued for discussion with client	24/09/2010	R.McG
5	Southern edge of house on erf. 56 located	13/10/2010	R.McG
6	Northern edge of house on erf. 25 located	13/10/2010	R.McG
7	Neighbouring stone boundary wall located	14/10/2010	R.McG
8	View towards Castle Rock indicated	14/10/2010	R.McG

Jo Noero is a registered architect with the SACAP - Reg. No. 3064  
Heinrich Wolff is a registered architect with the SACAP - Reg. No. 5550



136 Buttengracht  
P.O. Box 1058 Cape Town 8000  
Tel: (021) 422-1840  
Fax: (021) 422-1842  
robert@noerowolff.com  
www.noerowolff.com

Project Title:  
**House Herman**

Client:  
**Mr. & Mrs. Hugh & Jennifer Herman**

Site Location:  
**Erf. 27 Castle Rock**

Drawing Title:  
**SITE PLAN**

Date of Print: 2011/02/24 02:21:19 PM Date of Copy:

Drawing No: 001 Revision No: 6

50 cm  
30 cm  
0 cm  
Page Print Size: 441 x 258mm