

SPECIFICATIONS
 All work to be done from figured dimensions only. All work must comply with National Building Regulations SABS 0400. All dimensions and levels to be confirmed on site prior to the commencement of work. All dimensions to be confirmed on site before producing shop drawings or manufacturing of any component. All dimensions to be confirmed on site before ordering of any component.

STEELWORK & GALVANIZING
 All steelwork components to be formalized as shop drawings and issued for courtesy scrutiny by the architects and the engineers.
 Manufacture of steel components may only commence once shop drawings have been approved by the architects and the engineers.
 Scrutiny of shop drawings by the architects and the engineers is a courtesy and does not absolve the contractor nor sub-contractors from their responsibility of correctly manufacturing and installing steel components.
 All steelwork to be hot dip galvanized.
 All hot dip galvanizing to be carried out in accordance with SANS 121 (ISO 1461) and the recommendations of The Hot Dip Galvanizers Association of Southern Africa.
 All steel to be cut, grinded, drilled and welded prior to galvanizing.
 Any deviation from the architects drawings and engineers drawings to be approved by the architects and the engineers and formalized as shop drawings.
 On site cutting, grinding, drilling and welding may only be done with the approval of both the architects and the engineers. All repair work to galvanizing to be done using Zincrix zinc rich epoxy paint and to comply with SANS 121 (ISO 1461).

NOT FOR CONSTRUCTION

2	Sections located, room functions & datums	09/06/2010	R.McG
1	Issued to Ross Cameron	03/06/2010	R.McG
Rev.	Description	Date	Drawn
Jo Noero is a registered architect with the SACAP - Reg. No. 3064			
Heinrich Wolf is a registered architect with the SACAP - Reg. No. 5550			



136 Buitengracht
 P.O. Box 1058 Cape Town 8000
 Tel: (021) 422-1840
 Fax: (021) 422-1842
 robert@noerowolff.com
 www.noerowolff.com

Project Title:
House Herman

Client:
Mr. & Mrs. Hugh & Jennifer Herman

Site Location:
Erf. 27 Castle Rock

Drawing Title:
GROUND FLOOR PLAN

Date of Print:
 2010/06/09 12:34:22 PM

Date of Copy:

Drawing No:
101

Revision No:
2

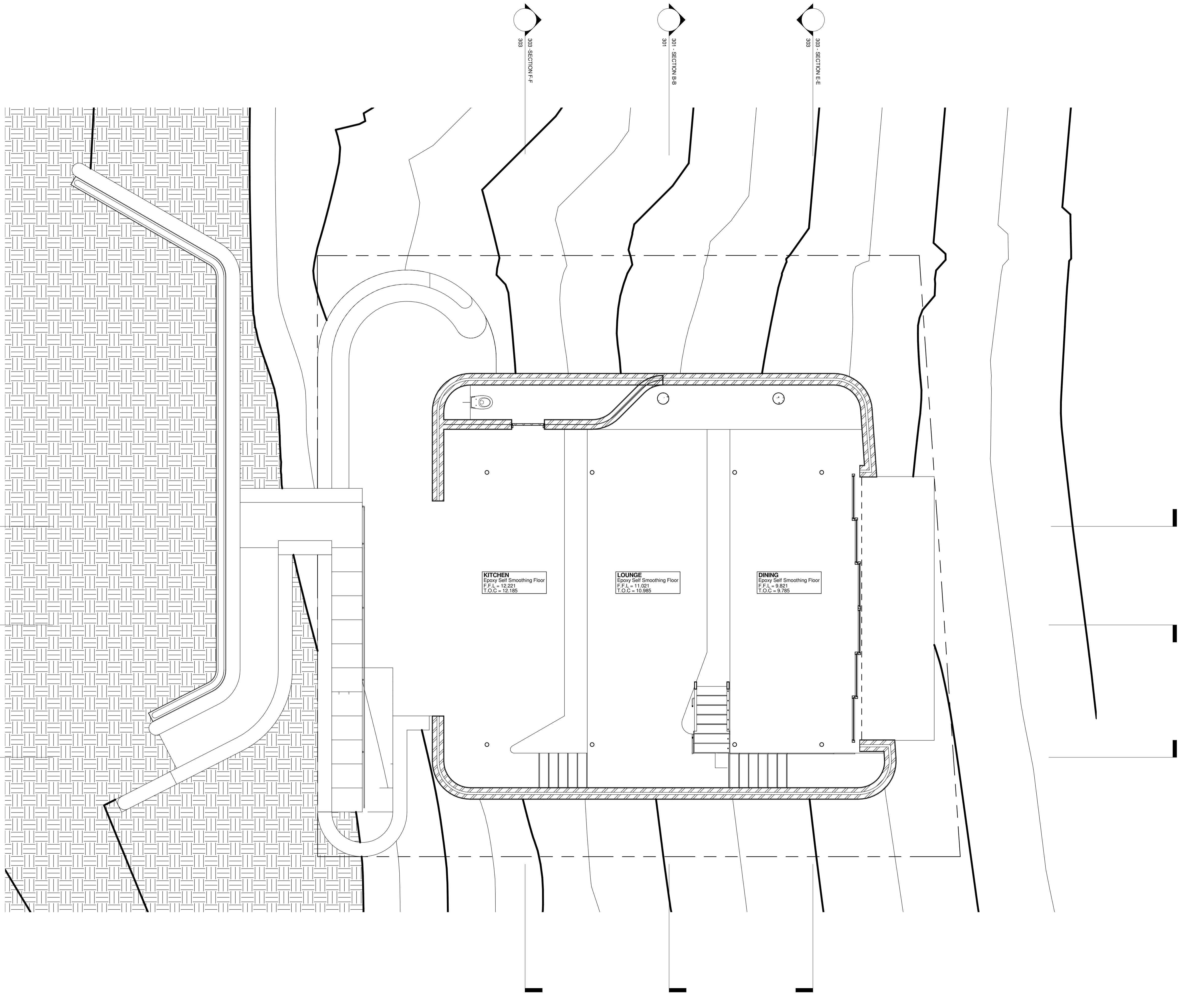

GROUND FLOOR PLAN
 1 : 50

301 - SECTION A-A
 301

302 - SECTION D-D
 302

302 - SECTION C-C
 302

303 - SECTION F-F
 303

301 - SECTION B-B
 301

303 - SECTION E-E
 303

KITCHEN
 Epoxy Self Smoothing Floor
 F.F.L = 12,221
 T.O.C = 12,185

LOUNGE
 Epoxy Self Smoothing Floor
 F.F.L = 11,021
 T.O.C = 10,985

DINING
 Epoxy Self Smoothing Floor
 F.F.L = 9,821
 T.O.C = 9,785

50 cm
30 cm
0 cm
Page Print Size: 841 x 594mm